

SHORT STROKE CYLINDERS RM/92000/M

Double acting – Ø 12 to 100 mm



One third the basic length of a corresponding ISO/VDMA model

Low friction, long life seal design

Fully non-corrodible specification

Standard magnetic piston for full control system versatility

TECHNICAL DATA

Medium:

Compressed air, filtered, lubricated or non-lubricated

Operation:

Double acting, magnetic piston non-cushioned

Operating pressure:

1 to 10 bar

Operating temperature:

-5°C to +80°C

Consult our Technical Service for use below +2°C

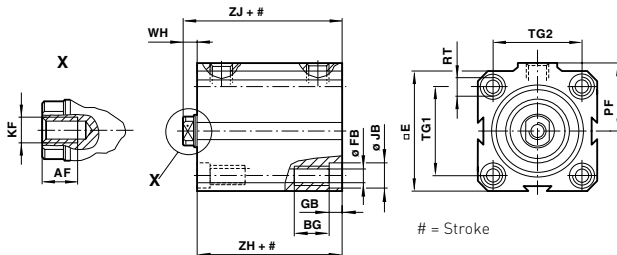

Dimensions

Dia. Ø	AF	BG	E	Ø FB	GB	Ø JB	KF	PF	RT	TG1	TG2	WH	ZH	ZJ
12	6	9	25	3,3	3,5	6	M 3	15	M 4	17	13	4,5	24	28,5
16	7	9	28	3,3	3,5	6	M 4	17	M 4	20	20	5,5	24,5	30
20	8	9	32	3,3	3,5	6	M 5	19,5	M 4	23	23	6	26	32
25	9	12	37	4,2	4,5	7,5	M 6	22	M 5	27	27	6,5	28,5	35
32	12	12	45	4,2	4,5	7,5	M 8	27,5	M 5	33	33	6,5	29	35,5
40	12	16	55	6,8	6,5	10,5	M 8	31,5	M 8	41	41	6,5	31,5	38
50	14	16	63	6,8	6,5	10,5	M 10	37	M 8	48	48	8	35	43
63	16	20	80	8,5	8,5	13,5	M 12	48	M 10	61	61	8	42,5	50,5
80	22	20	94	8,5	8,5	13,5	M 16	57	M 10	73	73	9	47	56
100	22	25	116,5	10,2	10,5	16,5	M 16	67	M 12	90,5	90,5	10	48,5	58,5

Models

Accessories

Model	Dia. Ø	Stroke length	Port size	Piston rod Ø	Reed switch with integral 5 m cable	Switch mounting	Banjo flow control	Straight fitting	Elbow fitting	Service kit
-------	--------	---------------	-----------	--------------	-------------------------------------	-----------------	--------------------	------------------	---------------	-------------



RM/92012/M/5	12	5	M5	6	M/50/LSU/5V	M/P72487	C0K510405	C02250405	C02470405	-
RM/92012/M/10	12	10	M5	6	M/50/LSU/5V	M/P72487	C0K510405	C02250405	C02470405	-
RM/92012/M/15	12	15	M5	6	M/50/LSU/5V	M/P72487	C0K510405	C02250405	C02470405	-
RM/92012/M/20	12	20	M5	6	M/50/LSU/5V	M/P72487	C0K510405	C02250405	C02470405	-
RM/92012/M/25	12	25	M5	6	M/50/LSU/5V	M/P72487	C0K510405	C02250405	C02470405	-
RM/92016/M/5	16	5	M5	8	M/50/LSU/5V	M/P72487	C0K510405	C02250405	C02470405	-
RM/92016/M/10	16	10	M5	8	M/50/LSU/5V	M/P72487	C0K510405	C02250405	C02470405	-
RM/92016/M/15	16	15	M5	8	M/50/LSU/5V	M/P72487	C0K510405	C02250405	C02470405	-
RM/92016/M/20	16	20	M5	8	M/50/LSU/5V	M/P72487	C0K510405	C02250405	C02470405	-
RM/92016/M/25	16	25	M5	8	M/50/LSU/5V	M/P72487	C0K510405	C02250405	C02470405	-
RM/92016/M/30	16	30	M5	8	M/50/LSU/5V	M/P72487	C0K510405	C02250405	C02470405	-
RM/92016/M/40	16	40	M5	8	M/50/LSU/5V	M/P72487	C0K510405	C02250405	C02470405	-
RM/92020/M/5	20	5	M5	10	M/50/LSU/5V	M/P72487	C0K510405	C02250405	C02470405	-
RM/92020/M/10	20	10	M5	10	M/50/LSU/5V	M/P72487	C0K510405	C02250405	C02470405	-
RM/92020/M/15	20	15	M5	10	M/50/LSU/5V	M/P72487	C0K510405	C02250405	C02470405	-
RM/92020/M/20	20	20	M5	10	M/50/LSU/5V	M/P72487	C0K510405	C02250405	C02470405	-
RM/92020/M/25	20	25	M5	10	M/50/LSU/5V	M/P72487	C0K510405	C02250405	C02470405	-

If you can't see the option you require...

...call the Express hotline now!

For further information
www.norgren.com/info/nec/en029



SHORT STROKE CYLINDERS RM/92000/M

Double acting - Ø 12 to 100 mm

Models

Accessories

Model	Dia. Ø	Stroke length	Port size	Piston rod Ø	Reed switch with integral 5m cable	Switch mounting	Banjo flow control	Straight fitting	Elbow fitting	Service kit
RM/92020/M/30	20	30	M5	10	M/50/LSU/5V	M/P72487	C0K510405	C02250405	C02470405	-
RM/92020/M/40	20	40	M5	10	M/50/LSU/5V	M/P72487	C0K510405	C02250405	C02470405	-
RM/92020/M/50	20	50	M5	10	M/50/LSU/5V	M/P72487	C0K510405	C02250405	C02470405	-
RM/92025/M/5	25	5	M5	12	M/50/LSU/5V	M/P72487	C0K510405	C02250405	C02470405	-
RM/92025/M/10	25	10	M5	12	M/50/LSU/5V	M/P72487	C0K510405	C02250405	C02470405	-
RM/92025/M/15	25	15	M5	12	M/50/LSU/5V	M/P72487	C0K510405	C02250405	C02470405	-
RM/92025/M/20	25	20	M5	12	M/50/LSU/5V	M/P72487	C0K510405	C02250405	C02470405	-
RM/92025/M/25	25	25	M5	12	M/50/LSU/5V	M/P72487	C0K510405	C02250405	C02470405	-
RM/92025/M/30	25	30	M5	12	M/50/LSU/5V	M/P72487	C0K510405	C02250405	C02470405	-
RM/92025/M/40	25	40	M5	12	M/50/LSU/5V	M/P72487	C0K510405	C02250405	C02470405	-
RM/92025/M/50	25	50	M5	12	M/50/LSU/5V	M/P72487	C0K510405	C02250405	C02470405	-
RM/92025/M/60	25	60	M5	12	M/50/LSU/5V	M/P72487	C0K510405	C02250405	C02470405	-
RM/92032/M/5	32	5	G1/8	16	M/50/LSU/5V	M/P72487	C0K510618	C02250618	C02470618	-
RM/92032/M/10	32	10	G1/8	16	M/50/LSU/5V	M/P72487	C0K510618	C02250618	C02470618	-
RM/92032/M/15	32	15	G1/8	16	M/50/LSU/5V	M/P72487	C0K510618	C02250618	C02470618	-
RM/92032/M/20	32	20	G1/8	16	M/50/LSU/5V	M/P72487	C0K510618	C02250618	C02470618	-
RM/92032/M/25	32	25	G1/8	16	M/50/LSU/5V	M/P72487	C0K510618	C02250618	C02470618	-
RM/92032/M/30	32	30	G1/8	16	M/50/LSU/5V	M/P72487	C0K510618	C02250618	C02470618	-
RM/92032/M/40	32	40	G1/8	16	M/50/LSU/5V	M/P72487	C0K510618	C02250618	C02470618	-
RM/92032/M/50	32	50	G1/8	16	M/50/LSU/5V	M/P72487	C0K510618	C02250618	C02470618	-
RM/92032/M/60	32	60	G1/8	16	M/50/LSU/5V	M/P72487	C0K510618	C02250618	C02470618	-
RM/92032/M/80	32	80	G1/8	16	M/50/LSU/5V	M/P72487	C0K510618	C02250618	C02470618	-
RM/92032/M/100	32	100	G1/8	16	M/50/LSU/5V	M/P72487	C0K510618	C02250618	C02470618	-
RM/92040/M/5	40	5	G1/8	16	M/50/LSU/5V	M/P72487	C0K510618	C02250618	C02470618	-
RM/92040/M/10	40	10	G1/8	16	M/50/LSU/5V	M/P72487	C0K510618	C02250618	C02470618	-
RM/92040/M/15	40	15	G1/8	16	M/50/LSU/5V	M/P72487	C0K510618	C02250618	C02470618	-
RM/92040/M/20	40	20	G1/8	16	M/50/LSU/5V	M/P72487	C0K510618	C02250618	C02470618	-
RM/92040/M/25	40	25	G1/8	16	M/50/LSU/5V	M/P72487	C0K510618	C02250618	C02470618	-
RM/92040/M/30	40	30	G1/8	16	M/50/LSU/5V	M/P72487	C0K510618	C02250618	C02470618	-
RM/92040/M/40	40	40	G1/8	16	M/50/LSU/5V	M/P72487	C0K510618	C02250618	C02470618	-
RM/92040/M/50	40	50	G1/8	16	M/50/LSU/5V	M/P72487	C0K510618	C02250618	C02470618	-
RM/92040/M/60	40	60	G1/8	16	M/50/LSU/5V	M/P72487	C0K510618	C02250618	C02470618	-
RM/92040/M/80	40	80	G1/8	16	M/50/LSU/5V	M/P72487	C0K510618	C02250618	C02470618	-
RM/92040/M/100	40	100	G1/8	16	M/50/LSU/5V	M/P72487	C0K510618	C02250618	C02470618	-
RM/92050/M/5	50	5	G1/8	20	M/50/LSU/5V	M/P72487	C0K510618	C02250618	C02470618	QM/92050/00
RM/92050/M/10	50	10	G1/8	20	M/50/LSU/5V	M/P72487	C0K510618	C02250618	C02470618	QM/92050/00
RM/92050/M/15	50	15	G1/8	20	M/50/LSU/5V	M/P72487	C0K510618	C02250618	C02470618	QM/92050/00
RM/92050/M/20	50	20	G1/8	20	M/50/LSU/5V	M/P72487	C0K510618	C02250618	C02470618	QM/92050/00
RM/92050/M/25	50	25	G1/8	20	M/50/LSU/5V	M/P72487	C0K510618	C02250618	C02470618	QM/92050/00
RM/92050/M/30	50	30	G1/8	20	M/50/LSU/5V	M/P72487	C0K510618	C02250618	C02470618	QM/92050/00
RM/92050/M/40	50	40	G1/8	20	M/50/LSU/5V	M/P72487	C0K510618	C02250618	C02470618	QM/92050/00
RM/92050/M/50	50	50	G1/8	20	M/50/LSU/5V	M/P72487	C0K510618	C02250618	C02470618	QM/92050/00
RM/92050/M/60	50	60	G1/8	20	M/50/LSU/5V	M/P72487	C0K510618	C02250618	C02470618	QM/92050/00
RM/92050/M/80	50	80	G1/8	20	M/50/LSU/5V	M/P72487	C0K510618	C02250618	C02470618	QM/92050/00
RM/92050/M/100	50	100	G1/8	20	M/50/LSU/5V	M/P72487	C0K510618	C02250618	C02470618	QM/92050/00
RM/92063/M/10	63	10	G1/4	20	M/50/LSU/5V	M/P72487	C0K510628	C02250628	C02470628	QM/92063/00
RM/92063/M/15	63	15	G1/4	20	M/50/LSU/5V	M/P72487	C0K510628	C02250628	C02470628	QM/92063/00
RM/92063/M/20	63	20	G1/4	20	M/50/LSU/5V	M/P72487	C0K510628	C02250628	C02470628	QM/92063/00
RM/92063/M/25	63	25	G1/4	20	M/50/LSU/5V	M/P72487	C0K510628	C02250628	C02470628	QM/92063/00
RM/92063/M/30	63	30	G1/4	20	M/50/LSU/5V	M/P72487	C0K510628	C02250628	C02470628	QM/92063/00
RM/92063/M/40	63	40	G1/4	20	M/50/LSU/5V	M/P72487	C0K510628	C02250628	C02470628	QM/92063/00
RM/92063/M/50	63	50	G1/4	20	M/50/LSU/5V	M/P72487	C0K510628	C02250628	C02470628	QM/92063/00
RM/92063/M/60	63	60	G1/4	20	M/50/LSU/5V	M/P72487	C0K510628	C02250628	C02470628	QM/92063/00
RM/92063/M/80	63	80	G1/4	20	M/50/LSU/5V	M/P72487	C0K510628	C02250628	C02470628	QM/92063/00
RM/92063/M/100	63	100	G1/4	20	M/50/LSU/5V	M/P72487	C0K510628	C02250628	C02470628	QM/92063/00
RM/92080/M/15	80	15	G1/4	25	M/50/LSU/5V	M/P72487	C0K510628	C02250628	C02470628	QM/92080/00
RM/92080/M/20	80	20	G1/4	25	M/50/LSU/5V	M/P72487	C0K510628	C02250628	C02470628	QM/92080/00
RM/92080/M/25	80	25	G1/4	25	M/50/LSU/5V	M/P72487	C0K510628	C02250628	C02470628	QM/92080/00
RM/92080/M/30	80	30	G1/4	25	M/50/LSU/5V	M/P72487	C0K510628	C02250628	C02470628	QM/92080/00
RM/92080/M/40	80	40	G1/4	25	M/50/LSU/5V	M/P72487	C0K510628	C02250628	C02470628	QM/92080/00
RM/92080/M/50	80	50	G1/4	25	M/50/LSU/5V	M/P72487	C0K510628	C02250628	C02470628	QM/92080/00
RM/92080/M/80	80	80	G1/4	25	M/50/LSU/5V	M/P72487	C0K510628	C02250628	C02470628	QM/92080/00
RM/92080/M/100	80	100	G1/4	25	M/50/LSU/5V	M/P72487	C0K510628	C02250628	C02470628	QM/92080/00

If you can't see the option you require...
...call the Express hotline now!

SHORT STROKE CYLINDERS RM/92000/M

Double acting – Ø 12 to 100 mm

Models

Accessories

Model	Dia. Ø	Stroke length	Port size	Piston rod Ø	Reed switch with integral 5 m cable	Switch mounting	Banjo flow control	Straight fitting	Elbow fitting	Service kit
RM/92100/M/15	100	15	G1/4	25	M/50/LSU/5V	M/P72487	C0K510628	C02250628	C02470628	QM/92100/00
RM/92100/M/20	100	20	G1/4	25	M/50/LSU/5V	M/P72487	C0K510628	C02250628	C02470628	QM/92100/00
RM/92100/M/25	100	25	G1/4	25	M/50/LSU/5V	M/P72487	C0K510628	C02250628	C02470628	QM/92100/00
RM/92100/M/30	100	30	G1/4	25	M/50/LSU/5V	M/P72487	C0K510628	C02250628	C02470628	QM/92100/00
RM/92100/M/40	100	40	G1/4	25	M/50/LSU/5V	M/P72487	C0K510628	C02250628	C02470628	QM/92100/00
RM/92100/M/50	100	50	G1/4	25	M/50/LSU/5V	M/P72487	C0K510628	C02250628	C02470628	QM/92100/00
RM/92100/M/80	100	80	G1/4	25	M/50/LSU/5V	M/P72487	C0K510628	C02250628	C02470628	QM/92100/00
RM/92100/M/100	100	100	G1/4	25	M/50/LSU/5V	M/P72487	C0K510628	C02250628	C02470628	QM/92100/00

Other stroke lengths available please call your Express Team
For information on additional magnetic switches see page 58

MOUNTINGS FOR RM/91000/M and RM/92000/M Short stroke cylinders

Single and double acting

Single and Double Acting

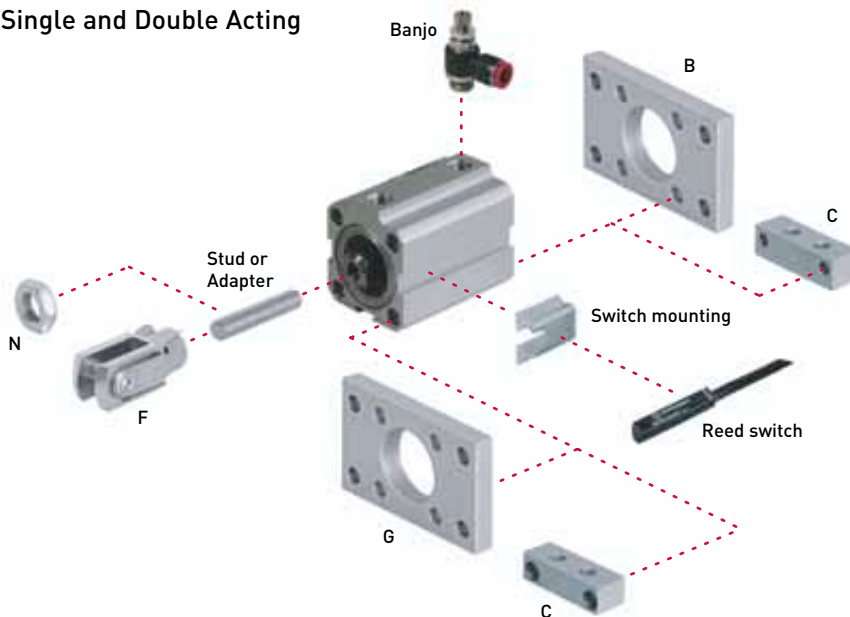

EXPRESS PLUS

Need a non-rotating piston rod?

Please call your Express Team



Dia. Ø	B, G	C	F	N	Stud or adaptor*
12	QM/90012/22	QM/90012/21	QM/57008/25	M/P1500/111	M/P1710/18
16	QM/90016/22	QM/90016/21	QM/8010/25	M/P1501/80	M/P1710/19
20	QM/90020/22	QM/90020/21	QM/92020/25	M/P1501/109	M/P1710/20
25	QM/90025/22	QM/90025/21	QM/57016/25	M/P1501/79	M/P1710/21
32	QM/90032/22	QM/90032/21	QM/57020/25	M/P1501/60	M/P1710/22
40	QM/90040/22	QM/90040/21	QM/57020/25	M/P1501/60	M/P1710/22
50	QM/90050/22	QM/90050/21	QM/57025/25	-	M/P71470/1
63	QM/90063/22	QM/90063/21	QM/57040/25	-	M/P71470/2
80	QM/90080/22	QM/90080/21	QM/57063/25	-	M/P71470/3
100	QM/90100/22	QM/90100/21	QM/57063/25	-	M/P71470/3

* For attaching F mounting to female piston rod thread

If you can't see the option you require...

...call the Express hotline now!