







ROUNDLINE CYLINDERS RM/55401/M

Double acting – Ø 32 to 63 mm

Models

Accessories

Model	Dia. Ø	Stroke length	Port size	Piston rod Ø	Reed switch with integral 5 m cable	Switch mounting	Banjo flow control	Straight fitting	Elbow fitting
									
RM/55441/M/25	40	25	G1/4	16	M/50/LSU/5V	QM/33/440/22	C0K510628	C02250628	C02470628
RM/55441/M/50	40	50	G1/4	16	M/50/LSU/5V	QM/33/440/22	C0K510628	C02250628	C02470628
RM/55441/M/80	40	80	G1/4	16	M/50/LSU/5V	QM/33/440/22	C0K510628	C02250628	C02470628
RM/55441/M/100	40	100	G1/4	16	M/50/LSU/5V	QM/33/440/22	C0K510628	C02250628	C02470628
RM/55441/M/125	40	125	G1/4	16	M/50/LSU/5V	QM/33/440/22	C0K510628	C02250628	C02470628
RM/55441/M/160	40	160	G1/4	16	M/50/LSU/5V	QM/33/440/22	C0K510628	C02250628	C02470628
RM/55441/M/200	40	200	G1/4	16	M/50/LSU/5V	QM/33/440/22	C0K510628	C02250628	C02470628
RM/55441/M/250	40	250	G1/4	16	M/50/LSU/5V	QM/33/440/22	C0K510628	C02250628	C02470628
RM/55441/M/300	40	300	G1/4	16	M/50/LSU/5V	QM/33/440/22	C0K510628	C02250628	C02470628
RM/55451/M/25	50	25	G1/4	20	M/50/LSU/5V	QM/33/450/22	C0K510828	C02250828	C02470828
RM/55451/M/50	50	50	G1/4	20	M/50/LSU/5V	QM/33/450/22	C0K510828	C02250828	C02470828
RM/55451/M/80	50	80	G1/4	20	M/50/LSU/5V	QM/33/450/22	C0K510828	C02250828	C02470828
RM/55451/M/100	50	100	G1/4	20	M/50/LSU/5V	QM/33/450/22	C0K510828	C02250828	C02470828
RM/55451/M/125	50	125	G1/4	20	M/50/LSU/5V	QM/33/450/22	C0K510828	C02250828	C02470828
RM/55451/M/160	50	160	G1/4	20	M/50/LSU/5V	QM/33/450/22	C0K510828	C02250828	C02470828
RM/55451/M/200	50	200	G1/4	20	M/50/LSU/5V	QM/33/450/22	C0K510828	C02250828	C02470828
RM/55451/M/250	50	250	G1/4	20	M/50/LSU/5V	QM/33/450/22	C0K510828	C02250828	C02470828
RM/55451/M/300	50	300	G1/4	20	M/50/LSU/5V	QM/33/450/22	C0K510828	C02250828	C02470828
RM/55464/M/25	63	25	G3/8	20	M/50/LSU/5V	QM/33/463/22	C0K510838	C02250838	C02470838
RM/55464/M/50	63	50	G3/8	20	M/50/LSU/5V	QM/33/463/22	C0K510838	C02250838	C02470838
RM/55464/M/80	63	80	G3/8	20	M/50/LSU/5V	QM/33/463/22	C0K510838	C02250838	C02470838
RM/55464/M/100	63	100	G3/8	20	M/50/LSU/5V	QM/33/463/22	C0K510838	C02250838	C02470838
RM/55464/M/125	63	125	G3/8	20	M/50/LSU/5V	QM/33/463/22	C0K510838	C02250838	C02470838
RM/55464/M/160	63	160	G3/8	20	M/50/LSU/5V	QM/33/463/22	C0K510838	C02250838	C02470838
RM/55464/M/200	63	200	G3/8	20	M/50/LSU/5V	QM/33/463/22	C0K510838	C02250838	C02470838
RM/55464/M/250	63	250	G3/8	20	M/50/LSU/5V	QM/33/463/22	C0K510838	C02250838	C02470838
RM/55464/M/300	63	300	G3/8	20	M/50/LSU/5V	QM/33/463/22	C0K510838	C02250838	C02470838

Other diameters and stroke lengths available please call your Express Team
Additional ranges available in dia. 80 and 100mm contact Norgren
For information on alternative magnetic switches see page 58

EXPRESS PLUS

Have you thought about...

- Setting air pressure as low as possible to suit the application will save money – always fit pressure regulators
- When moving light loads in only one direction, the use of single acting cylinders saves money

If you can't see the option you require...
...call the Express hotline now!

MOUNTINGS FOR RM/55401/M Roundline cylinders

Ø 32 ... 63 mm

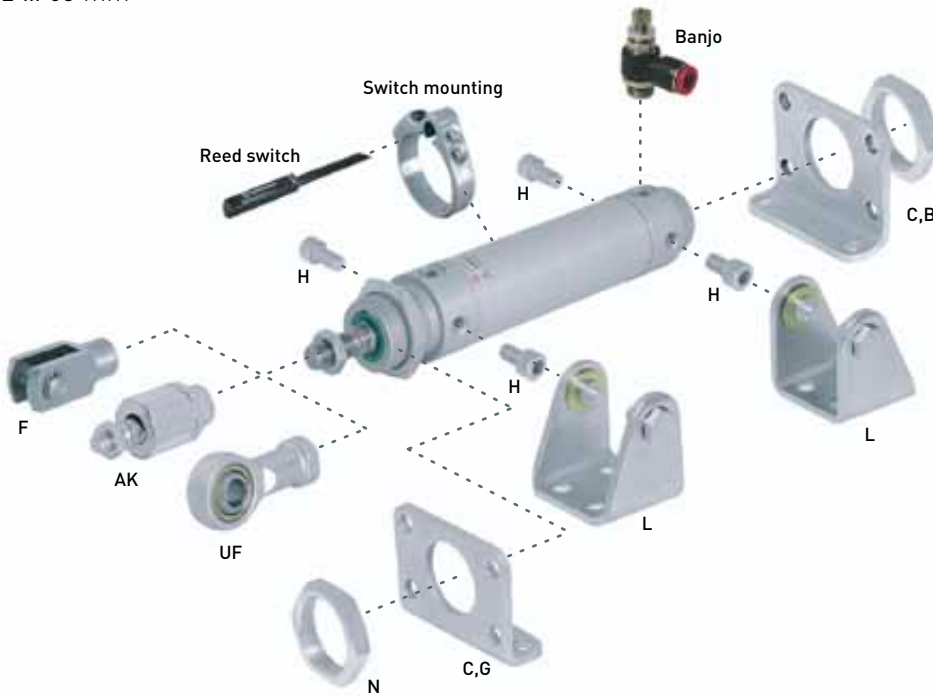

Dia. Ø	AK	B, G	C	F	H	L	N	UF
32	QM/8025/38	QM/55232/22	QM/55232/21	QM/8025/25	QM/55232/28	QM/55232/24	M/P29254	QM/8025/32
40	QM/8040/38	QM/55240/22	QM/55240/21	QM/8040/25	QM/55240/28	QM/55240/24	M/P29255	QM/8040/32
50	QM/8050/38	QM/55250/22	QM/55250/21	QM/8050/25	QM/55250/28	QM/55250/24	M/P29256	QM/8050/32
63	QM/8050/38	QM/55263/22	QM/55263/21	QM/8050/25	QM/55263/28	QM/55263/24	M/P29256	QM/8050/32

If you can't see the option you require...
...call the Express hotline now!