

ISO COMPACT CYLINDERS RA/192000/M

Double acting – Ø 20 ... 125 mm



- Conforms to ISO 21287
- Magnetic piston as standard
- Low friction, long life seals
- Switches can be mounted flush with the profile

TECHNICAL DATA

- Medium:**
Compressed air, filtered, lubricated or non-lubricated
- Operation:**
RA/192000/M
Double acting, magnetic piston, male piston rod thread, buffer cushioning
RA/192000/MX
Double acting, magnetic piston, female piston rod thread, buffer cushioning
- Operating pressure:**
1 to 10 bar
- Operating temperature:**
–5°C to +80°C max.
Consult our Technical Service for use below +2°C.

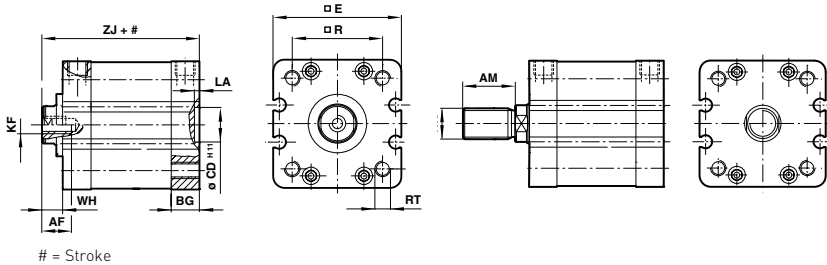

Dimensions

Dia. Ø	AF	AM	BG	Ø CDH11	E	KF	KK	LA	R	RT	WH	ZJ
20	10	16	12	10	37	M6	M8x1,25	2,5	22	M5	6	43
25	10	16	13	10	41	M6	M8x1,25	2,5	26	M5	6	45
32	12	19	14,5	14	48	M8	M10x1,25	2,5	32,5	M6	7	51
40	12	19	14,5	14	54,5	M8	M10x1,25	2,5	38	M6	7	52
50	16	22	14	18	66	M10	M12x1,25	2,5	46,5	M8	8	53
63	16	22	14	18	76	M10	M12x1,25	2,5	56,5	M8	8	57
80	20	28	15,5	23	96	M12	M16x1,5	3	72	M10	10	64
100	20	28	21,5	26	116	M12	M16x1,5	3	89	M10	10	77
125	30	54	20,5	28	142	M20	M27x2	3	110	M12	18	89

Models

MALE THREAD Model	FEMALE THREAD Model	Dia. Ø	Stroke length	Port size	Piston rod Ø
-------------------	---------------------	--------	---------------	-----------	--------------

Accessories

Reed switch with integral 5 m cable	Banjo flow control	Straight fitting	Elbow fitting	Service kit
-------------------------------------	--------------------	------------------	---------------	-------------



RA/192020/MX/10	RA/192020/M/10	20	10	M5	10	M/50/LSU/5V	C0K510405	C02250405	C02470405	QM/192020/00
RA/192020/MX/15	RA/192020/M/15	20	15	M5	10	M/50/LSU/5V	C0K510405	C02250405	C02470405	QM/192020/00
RA/192020/MX/20	RA/192020/M/20	20	20	M5	10	M/50/LSU/5V	C0K510405	C02250405	C02470405	QM/192020/00
RA/192025/MX/10	RA/192025/M/10	25	10	M5	10	M/50/LSU/5V	C0K510405	C02250405	C02470405	QM/192025/00
RA/192025/MX/15	RA/192025/M/15	25	15	M5	10	M/50/LSU/5V	C0K510405	C02250405	C02470405	QM/192025/00
RA/192025/MX/20	RA/192025/M/20	25	20	M5	10	M/50/LSU/5V	C0K510405	C02250405	C02470405	QM/192025/00
RA/192025/MX/25	RA/192025/M/25	25	25	M5	10	M/50/LSU/5V	C0K510405	C02250405	C02470405	QM/192025/00

If you can't see the option you require...
...call the Express hotline now!

For further information
www.norgren.com/info/nec/en025









COMPACT CYLINDERS RA/192

Double acting – Ø 20 ... 125 mm

Models

Accessories

MALE THREAD Model	FEMALE THREAD Model	Dia. Ø	Stroke	Port size	Piston rod Ø	Reed switch with integral 5 m cable	Banjo flow control	Straight fitting	Elbow fitting	Service kit
										
RA/192032/MX/10	RA/192032/M/10	32	10	G1/8	12	M/50/LSU/5V	C0K510618	C02250618	C02470618	QM/192032/00
RA/192032/MX/15	RA/192032/M/15	32	15	G1/8	12	M/50/LSU/5V	C0K510618	C02250618	C02470618	QM/192032/00
RA/192032/MX/20	RA/192032/M/20	32	20	G1/8	12	M/50/LSU/5V	C0K510618	C02250618	C02470618	QM/192032/00
RA/192032/MX/25	RA/192032/M/25	32	25	G1/8	12	M/50/LSU/5V	C0K510618	C02250618	C02470618	QM/192032/00
RA/192032/MX/30	RA/192032/M/30	32	30	G1/8	12	M/50/LSU/5V	C0K510618	C02250618	C02470618	QM/192032/00
RA/192032/MX/40	RA/192032/M/40	32	40	G1/8	12	M/50/LSU/5V	C0K510618	C02250618	C02470618	QM/192032/00
RA/192032/MX/50	RA/192032/M/50	32	50	G1/8	12	M/50/LSU/5V	C0K510618	C02250618	C02470618	QM/192032/00
RA/192032/MX/60	RA/192032/M/60	32	60	G1/8	12	M/50/LSU/5V	C0K510618	C02250618	C02470618	QM/192032/00
RA/192032/MX/80	RA/192032/M/80	32	80	G1/8	12	M/50/LSU/5V	C0K510618	C02250618	C02470618	QM/192032/00
RA/192032/MX/100	RA/192032/M/100	32	100	G1/8	12	M/50/LSU/5V	C0K510618	C02250618	C02470618	QM/192032/00
RA/192040/MX/10	RA/192040/M/10	40	10	G1/8	16	M/50/LSU/5V	C0K510618	C02250618	C02470618	QM/192040/00
RA/192040/MX/15	RA/192040/M/15	40	15	G1/8	16	M/50/LSU/5V	C0K510618	C02250618	C02470618	QM/192040/00
RA/192040/MX/20	RA/192040/M/20	40	20	G1/8	16	M/50/LSU/5V	C0K510618	C02250618	C02470618	QM/192040/00
RA/192040/MX/25	RA/192040/M/25	40	25	G1/8	16	M/50/LSU/5V	C0K510618	C02250618	C02470618	QM/192040/00
RA/192040/MX/30	RA/192040/M/30	40	30	G1/8	16	M/50/LSU/5V	C0K510618	C02250618	C02470618	QM/192040/00
RA/192040/MX/40	RA/192040/M/40	40	40	G1/8	16	M/50/LSU/5V	C0K510618	C02250618	C02470618	QM/192040/00
RA/192040/MX/50	RA/192040/M/50	40	50	G1/8	16	M/50/LSU/5V	C0K510618	C02250618	C02470618	QM/192040/00
RA/192040/MX/60	RA/192040/M/60	40	60	G1/8	16	M/50/LSU/5V	C0K510618	C02250618	C02470618	QM/192040/00
RA/192040/MX/80	RA/192040/M/80	40	80	G1/8	16	M/50/LSU/5V	C0K510618	C02250618	C02470618	QM/192040/00
RA/192040/MX/100	RA/192040/M/100	40	100	G1/8	16	M/50/LSU/5V	C0K510618	C02250618	C02470618	QM/192040/00
RA/192050/MX/10	RA/192050/M/10	50	10	G1/8	20	M/50/LSU/5V	C0K510618	C02250618	C02470618	QM/192050/00
RA/192050/MX/15	RA/192050/M/15	50	15	G1/8	20	M/50/LSU/5V	C0K510618	C02250618	C02470618	QM/192050/00
RA/192050/MX/20	RA/192050/M/20	50	20	G1/8	20	M/50/LSU/5V	C0K510618	C02250618	C02470618	QM/192050/00
RA/192050/MX/25	RA/192050/M/25	50	25	G1/8	20	M/50/LSU/5V	C0K510618	C02250618	C02470618	QM/192050/00
RA/192050/MX/30	RA/192050/M/30	50	30	G1/8	20	M/50/LSU/5V	C0K510618	C02250618	C02470618	QM/192050/00
RA/192050/MX/40	RA/192050/M/40	50	40	G1/8	20	M/50/LSU/5V	C0K510618	C02250618	C02470618	QM/192050/00
RA/192050/MX/50	RA/192050/M/50	50	50	G1/8	20	M/50/LSU/5V	C0K510618	C02250618	C02470618	QM/192050/00
RA/192050/MX/60	RA/192050/M/60	50	60	G1/8	20	M/50/LSU/5V	C0K510618	C02250618	C02470618	QM/192050/00
RA/192050/MX/80	RA/192050/M/80	50	80	G1/8	20	M/50/LSU/5V	C0K510618	C02250618	C02470618	QM/192050/00
RA/192050/MX/100	RA/192050/M/100	50	100	G1/8	20	M/50/LSU/5V	C0K510618	C02250618	C02470618	QM/192050/00
RA/192063/MX/10	RA/192063/M/10	63	10	G1/8	20	M/50/LSU/5V	C0K510618	C02250618	C02470618	QM/192063/00
RA/192063/MX/15	RA/192063/M/15	63	15	G1/8	20	M/50/LSU/5V	C0K510618	C02250618	C02470618	QM/192063/00
RA/192063/MX/20	RA/192063/M/20	63	20	G1/8	20	M/50/LSU/5V	C0K510618	C02250618	C02470618	QM/192063/00
RA/192063/MX/25	RA/192063/M/25	63	25	G1/8	20	M/50/LSU/5V	C0K510618	C02250618	C02470618	QM/192063/00
RA/192063/MX/30	RA/192063/M/30	63	30	G1/8	20	M/50/LSU/5V	C0K510618	C02250618	C02470618	QM/192063/00
RA/192063/MX/40	RA/192063/M/40	63	40	G1/8	20	M/50/LSU/5V	C0K510618	C02250618	C02470618	QM/192063/00
RA/192063/MX/50	RA/192063/M/50	63	50	G1/8	20	M/50/LSU/5V	C0K510618	C02250618	C02470618	QM/192063/00
RA/192063/MX/60	RA/192063/M/60	63	60	G1/8	20	M/50/LSU/5V	C0K510618	C02250618	C02470618	QM/192063/00
RA/192063/MX/80	RA/192063/M/80	63	80	G1/8	20	M/50/LSU/5V	C0K510618	C02250618	C02470618	QM/192063/00
RA/192063/MX/100	RA/192063/M/100	63	100	G1/8	20	M/50/LSU/5V	C0K510618	C02250618	C02470618	QM/192063/00
RA/192080/MX/15	RA/192080/M/15	80	15	G1/8	25	M/50/LSU/5V	C0K510818	C02250818	C02470818	QM/192080/00
RA/192080/MX/20	RA/192080/M/20	80	20	G1/8	25	M/50/LSU/5V	C0K510818	C02250818	C02470818	QM/192080/00
RA/192080/MX/25	RA/192080/M/25	80	25	G1/8	25	M/50/LSU/5V	C0K510818	C02250818	C02470818	QM/192080/00
RA/192080/MX/30	RA/192080/M/30	80	30	G1/8	25	M/50/LSU/5V	C0K510818	C02250818	C02470818	QM/192080/00
RA/192080/MX/40	RA/192080/M/40	80	40	G1/8	25	M/50/LSU/5V	C0K510818	C02250818	C02470818	QM/192080/00
RA/192080/MX/50	RA/192080/M/50	80	50	G1/8	25	M/50/LSU/5V	C0K510818	C02250818	C02470818	QM/192080/00
RA/192100/MX/25	RA/192100/M/25	100	25	G1/8	25	M/50/LSU/5V	C0K510818	C02250818	C02470818	QM/192100/00
RA/192125/MX/25	RA/192125/M/25	125	25	G1/4	32	M/50/LSU/5V	C0K510828	C02250828	C02470828	QM/192125/00

Other stroke lengths available please call your Express Team
For information on alternative magnetic switches see page 58

If you can't see the option you require...
...call the Express hotline now!

MOUNTINGS FOR RA/191000/M and RA/193000/M and RA/192000/M Compact cylinders

■ Male and Female Piston Rod Thread

■ Male Piston Rod Thread Only

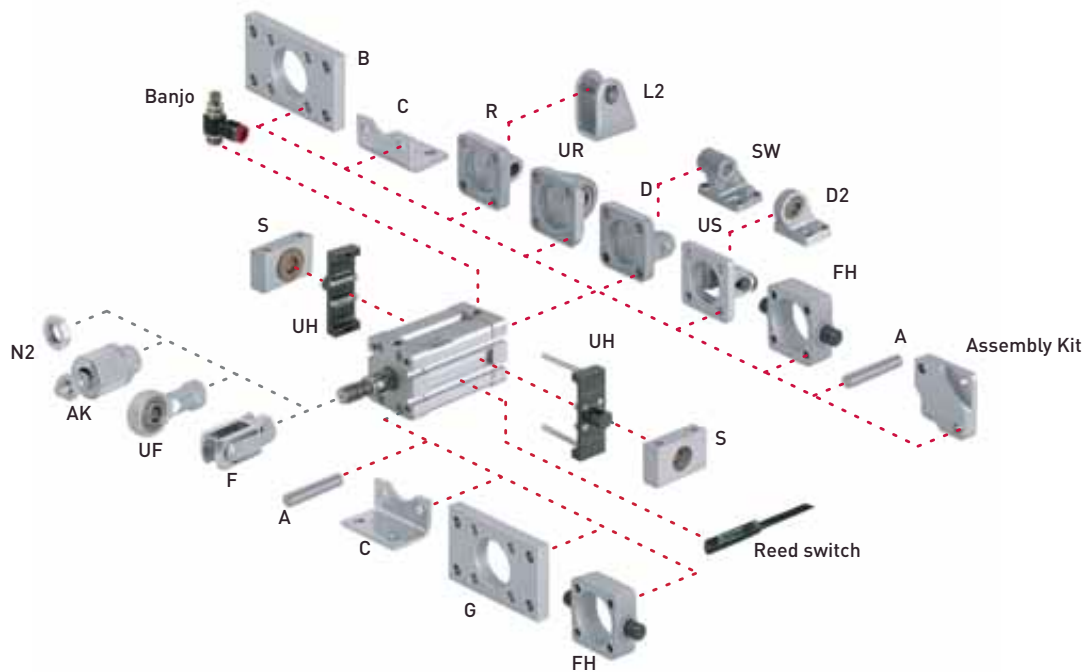

For cylinders with male and female piston rod thread

Dia. Ø	A	B, G	C	D	D2	FH	L2
20	-	QA/192020/22	QM/192020/21	-	-	-	QM/8020/44
25	-	QA/192025/22	QM/192025/21	-	-	-	QM/8020/44
32	QM/8032/35	QA/8032/22	QA/192032/21	QA/8032/23	QA/8032/42	QA/8032/34	-
40	QM/8032/35	QA/8040/22	QA/192040/21	QA/8040/23	QA/8040/42	QA/8040/34	-
50	QM/8050/35	QA/8050/22	QA/192050/21	QA/8050/23	QA/8050/42	QA/8050/34	-
63	QM/8050/35	QA/8063/22	QA/192063/21	QA/8063/23	QA/8063/42	QA/8063/34	-
80	QM/8080/35	QA/8080/22	QA/192080/21	QA/8080/23	QA/8080/42	QA/8080/34	-
100	QM/8080/35	QA/8100/22	QA/192100/21	QA/8100/23	QA/8100/42	QA/8100/34	-
125	QM/8125/35	QM/8125/22	QM/8125/21	QM/8125/23	QA/8125/42	QA/8125/34	-

Dia. Ø	R	S	SW	UH	UR	US	Assembly kit
20	QM/192020/27	-	-	-	-	-	QA/192020/55
25	QM/192025/27	-	-	-	-	-	QA/192025/55
32	QA/8032/27	QA/8032/41	M/P19493	PQA/182032/40	QA/8032/33	M/P40310	QA/192032/55
40	QA/8040/27	QA/8040/41	M/P19494	PQA/182040/40	QA/8040/33	M/P40311	QA/192040/55
50	QA/8050/27	QA/8040/41	M/P19495	PQA/182050/40	QA/8050/33	M/P40312	QA/192050/55
63	QA/8063/27	QA/8063/41	M/P19496	PQA/182063/40	QA/8063/33	M/P40313	QA/192063/55
80	QA/8080/27	QA/8063/41	M/P19497	PQA/182080/40	QA/8080/33	M/P40314	QA/192080/55
100	QA/8100/27	QA/8100/41	M/P19498	PQA/182100/40	QA/8100/33	M/P40315	QA/192100/55
125	QM/8125/27	QA/8100/41	M/P19499	PQA/182125/40	QM/8125/33	M/P71355	QA/192125/55

For cylinders with male piston rod thread

Dia. Ø	AK	F	N2	UF
20	QM/8020/38	QM/8020/25	M/P1501/60	QM/8020/32
25	QM/8020/38	QM/8020/25	M/P1501/60	QM/8020/32
32	QM/8025/38	QM/8025/25	M/P1501/89	QM/8025/32
40	QM/8025/38	QM/8025/25	M/P1501/89	QM/8025/32
50	QM/8040/38	QM/8040/25	M/P1501/90	QM/8040/32
63	QM/8040/38	QM/8040/25	M/P1501/90	QM/8040/32
80	QM/8050/38	QM/8050/25	M/P1501/91	QM/8050/32
100	QM/8050/38	QM/8050/25	M/P1501/91	QM/8050/32
125	QM/8125/38	QM/8125/25	M/P1501/105	QM/8125/32

EXPRESS PLUS

Need a non-rotating piston rod?

Please call your Express Team



If you can't see the option you require...

...call the Express hotline now!