

# PROPORTIONAL PRESSURE CONTROL VALVE

## VP10 Series

G1/4

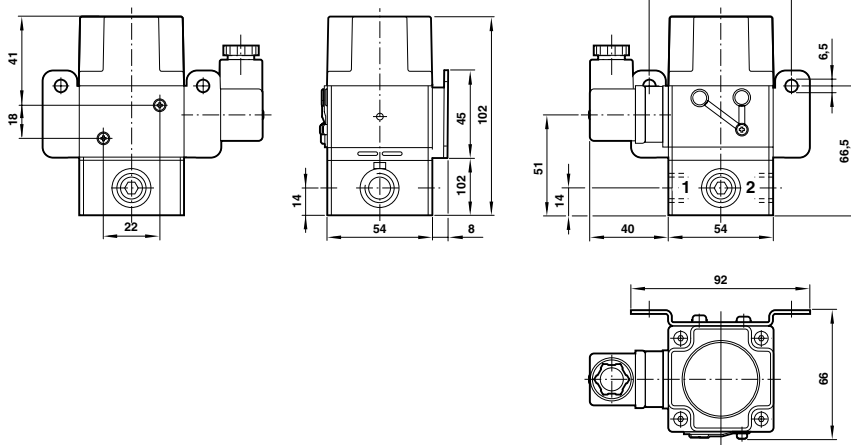

**Air piloted proportional pressure valve**

**Reliable, rugged design**

**Excellent accuracy**

**IP 65 environmental protection in normal position**

### TECHNICAL DATA

**Medium:**

Oil free, dry air, filtered to 5 µm

**Output pressure:**

0,2–1,0 bar, 0,2–2,0 bar, 0,2–4 bar (2 wire version)

0,14–6,0 bar, 0,14–8 bar (3 wire version)

**Flow capacity:**

Up to 300 l/min

**Air consumption:**

<4 bar: 0,85 l/min typical, >4 bar: 1,75 l/min typical

**Operating pressure:**

At least 0,7 bar above maximum required output pressure

**Operating temperature range:**

-20 ... +70 °C

Consult our Technical Service for use below +2°C

**Response time:**

<2 bar: less than 0,5 s for 10...90% step change

>2 bar: 2 s for 10...90% step change

**Total error:**

±0,5% of span (typical, independent error includes the combined effect of non-linearity, hysteresis, deadzone and repeatability)

**Temperature effect:**

Typically 0,1% of span/°C for span and zero over operating range

**Supply sensitivity:**

>0,025% span output change per % supply pressure change

**Failure mode:**

Signal falls to bleed pressure when electrical supply fails

**Mounting:**

Integral surface mounting bracket provided for referred vertical mounting. 50 mm pipe mounting kit available.

### Models

Model	Port size	Flow (l/min)	Control signal	Output pressure (bar)
VP1001BJ400A00	G1/4	300	4... 20 mA	0,2... 1
VP1006BJ401A00	G1/4	300	4... 20 mA	0,14... 6
VP1008BJ401A00	G1/4	300	4... 20 mA	0,14... 6

For further information  
[www.norgren.com/info/nec/en119](http://www.norgren.com/info/nec/en119)

