

# BSP & HOSE FITTINGS

M5, 1/8" to 1" BSP



- Bright nickel plated.
- Corrosion resistant.
- Compact design.
- Washers included where necessary.

## TECHNICAL DATA

### Medium:

Compressed air or any fluids compatible with the materials listed opposite.

### Operating pressure:

Generally limited by tubing specification except where plastic sealing washers are used (banjo bolts and M5 units). In these cases pressure is limited to 18 bar. Suitable for vacuum applications. flow regulating banjos are limited to 1 to 10 bar operating range.

### Ambient temperature:

Generally limited by tubing specification except where plastic sealing washers are used (banjo bolts, and M5 units). In these cases temperature is limited to +70°C.

## MATERIALS

**Bar parts:** Brass to BS 2874: 1986 [CZ 121], bright nickel plated

**Stamped parts:** Brass to BS 2872: 1969 [CZ 122], bright nickel plated

**Sealing washers:** Copper [Delrin for M5 items]

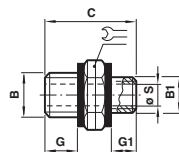

### Nipple Adaptor

Model No.	Metric & BSPP Thread (B)	Metric & BSPP Thread (B1)	C	G	G1	ØS	
160200505	M5	M5	11,5	4	4	2	8
160201805	G1/8	M5	14,5	6	4	2	14
160201818	G1/8	G1/8	16,5	6	6	5,5	14
160202818	G1/4	G1/8	19	8	6	5,5	17
160202828	G1/4	G1/4	21	8	8	8	17
160203828	G3/8	G1/4	22	9	8	8	19
160203838	G3/8	G3/8	23	9	9	11	19
160204828	G1/2	G1/4	23,5	10	8	8	24
160204838	G1/2	G3/8	24,5	10	9	11	24
160204848	G1/2	G1/2	25,5	10	10	15	24
160206848	G3/4	G1/2	27,5	12	10	15	30
160206868	G3/4	G3/4	53	14,5	14,5	18	32
160208848	G1	G1/2	56,5	17,5	13,5	14	41
160208868	G1	G3/4	58	17,5	14,5	18	41
160208888	G1	G1	61	17,5	17,5	25	41

Supplied with sealing washers.

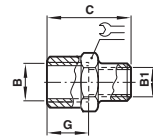

### Sleeve Adaptor

Model No.	Metric & BSPP Thread (B)	Metric & BSPP Thread (B1)	C	G	
160220505	M5	M5	11	11	8
160221805	G1/8	M5	13	7,5	14
160221818	G1/8	G1/8	15	15	14
160222818	G1/4	G1/8	19	9,5	17
160222828	G1/4	G1/4	22	22	17
160223818	G3/8	G1/8	20	10,5	22
160223828	G3/8	G1/4	23	10,5	22
160223838	G3/8	G3/8	24	24	22
160224818	G1/2	G1/8	24	13	24
160224828	G1/2	G1/4	25	13	24
160224838	G1/2	G3/8	27,5	13	24
160224848	G1/2	G1/2	30	30	26
160226848	G3/4	G1/2	30	14,5	30
160226868	G3/4	G3/4	31	31	32
160228868	G1	G3/4	39	17	40
160228888	G1	G1	45,5	46,5	41

For further information  
[www.norgren.com/info/nec/en261](http://www.norgren.com/info/nec/en261)



## BSP & HOSE FITTINGS

M5, 1/8" to 1" BSP

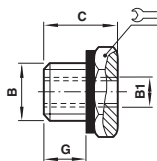

### BSP Connector

Model No.	Reducing Male BSPP (B)	Female and BSPP Thread (B1)	C	G	
160231805	G1/8	M5	10,5	6	14
160232805	G1/4	M5	15,5	7,5	17
160232818	G1/4	G1/8	13	8	17
160233818	G3/8	G1/8	14	9	19
160233828	G3/8	G1/4	14	9	19
160234818	G1/2	G1/8	15,5	10	24
160234828	G1/2	G1/4	15,5	10	24
160234838	G1/2	G3/8	15,5	10	24
160236828	G3/4	G1/4	23	14	32
160236838	G3/4	G3/8	17,5	12	30
160236848	G3/4	G1/2	17,5	12	30

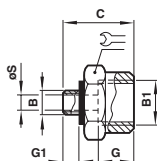

Model No.	Metric & BSPP Thread (B)	Female BSPP (B1)	C	G	G1	ØS	
160230518	M5	G1/8	14,5	4	7,5	2	14
160231828	G1/8	G1/4	19,5	6	9,5	5,5	17
160231838	G1/8	G3/8	21	6	10,5	5,5	22
160232838	G1/4	G3/8	22,5	8	10,5	8	22
160232848	G1/4	G1/2	26	8	13	8	26
160232868	G1/4	G3/4	33	7,5	16,5	6,5	32
160233848	G3/8	G1/2	27	9	13	11	26
160233868	G3/8	G3/4	34	8,5	16,5	9,5	32
160234868	G1/2	G3/4	38	11,5	16,5	13,5	32

Supplied with sealing washer.

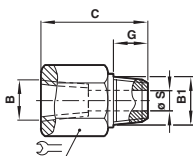

### Adaptor

Model No.	Female NPTF (B)	Male BSPT (B1)	C	G	ØS	
154231818	1/8 NPT	R1/8	27,5	9,5	4,5	15
154232828	1/8 NPT	R1/4	36	11	7,5	19
154233838	3/8 NPT	R3/8	38	12,5	9,5	22
154234848	1/2 NPT	R1/2	47	16	13	27
154236868	3/4 NPT	R3/4	50	19	17,5	36

Model No.	Female BSPP (B)	Male BSPT (B1)	C	G	ØS	
172232828	G1/4	1/8 NPT	33,5	14,5	7,5	19
172233838	G3/8	3/8 NPT	33,5	14,5	9,5	24
172234848	G1/2	1/2 NPT	44	19	12,5	27

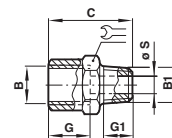

### BSP Connector

REDUCING							
Model No.	Male BSPT (B)	Female BSPP (B1)	C	G	G1	ØS	
150231818	R1/8	G1/8	20	7,5	7,5	5,5	14
150232818	R1/4	G1/8	16	11	7,5	5,5	14
150232828	R1/4	G1/4	26	11	9,5	8	17
150233818	R3/8	G1/8	16,5	11,5	7,5	5,5	17
150233828	R3/8	G1/4	16,5	11,5	9,5	8	17
150233838	R3/8	G3/8	27,5	11,5	10,5	11	22
150234818	R1/2	G1/8	19,5	14	7,5	5,5	22
150234828	R1/2	G1/4	19,5	14	9,5	8	22
150234838	R1/2	G3/8	19,5	14	10,5	11	22
150234848	R1/2	G1/2	33	14	13	15	26
150236828	R3/4	G1/4	29,5	18,5	11	11,5	27
150236838	R3/4	G3/8	23,5	16,5	10,5	11	27
150236848	R3/4	G1/2	23,5	16,5	13	15	27
150238838	R1	G3/8	34,5	21,5	14	15	35
150238848	R1	G1/2	26,5	19	13	15	34
150238868	R1	G3/4	26,5	19	14,5	19	34

EXPANDING							
Model No.	Male BSPT (B)	Female BSPP (B1)	C	G	G1	ØS	
150231828	R1/8	G1/4	22	7,5	9,5	5	17
150231838	R1/8	G3/8	22,5	7,5	10,5	5	22
150231848	R1/8	G1/2	31	8,5	15	5	27
150232838	R1/4	G3/8	27	11	10,5	8	22
150232848	R1/4	G1/2	30	11	13	8	26
150232868	R1/4	G3/4	37,5	11	16,5	7	32
150233848	R3/8	G1/2	30,5	11,5	13	11	26
150233868	R3/8	G3/4	38,5	12,5	16,5	11	32
150234868	R1/2	G3/4	35	14	14,5	15	32
150236888	R3/4	G1	45	19	19	18	41

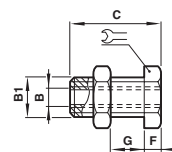

### Bulkhead Connector

Model No.	Metric & BSPP Thread (B)	Male Metric Thread (B1)	C	F	G max.	
160290005	M5	M10X1,0	14	3,5	7	14
160290018	G1/8	M16X1,5	18	4	10	22
160290028	G1/4	M20X1,5	25	4	16	27
160290038	G3/8	M26X1,5	26	5	15	32
160290048	G1/2	M28X1,5	33	6	21	36
160290068	G3/4	M33X1,5	36,5	6	22,5	41
160290088	G1	M42X1,5	41,5	8	24,5	46
1602900A8	G1 1/4	M48X1,5	50	8	29,5	55

Supplied with locknut

## BSP & HOSE FITTINGS

M5, 1/8" to 1" BSP

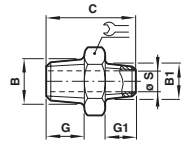

Nipple Adaptor

Model No.	BSPT Thread (B)	BSPT Thread (B1)	C	G	G1	ØS	
150201818	R1/8	R1/8	19,5	7,5	7,5	5,5	12
150202818	R1/4	R1/8	23,5	11	7,5	5,5	14
150202828	R1/4	R1/4	27	11	11	6,4	14
150203818	R3/8	R1/8	24	11,5	7,5	5,5	17
150203828	R3/8	R1/4	27,5	11,5	11	8	17
150203838	R3/8	R3/8	28	11,5	11,5	11	17
150204818	R1/2	R1/8	27	14	7,5	5,5	22
150204828	R1/2	R1/4	30,5	14	11	8	22
150204838	R1/2	R3/8	31	14	11,5	11	22
150204848	R1/2	R1/2	33,5	14	14	15	22
150206828	R3/4	R1/4	37	19	11	6,4	27
150206838	R3/4	R3/8	39	19	12,5	9	27
150206848	R3/4	R1/2	37,5	16	14	15	27
150206868	R3/4	R3/4	40	16,5	16,5	19	27
150208838	R1	R3/8	43	22	12,5	9	36
150208848	R1	R1/2	46	22	16	12,5	36
150208868	R1	R3/4	43	19	16,5	19	34
150208888	R1	R1	45,5	19	19	23	34

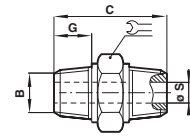

Hexagon Nipple

Model No.	Male BSPT (A)	Male NPTF (B)	C	ØD	G	G1	
154201818	1/8 NPT	R1/8	27	4,5	9,5	9,5	11
154202828	1/8 NPT	R1/4	3,5	7,5	11	14,5	14
154203838	3/8 NPT	R3/8	37	9,5	12,5	14,5	17
154204848	1/2 NPT	R1/2	46,5	12,5	16	19	22
154206868	3/4 NPT	R3/4	47,5	17,5	19	19	27

Adaptor fittings – allow connection between components and system using BSP or NPT threads

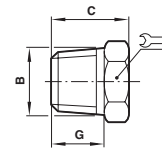

Plug

Model No.	BSPT Thread (B)	C	G	
150050028	R1/4	16,5	11	14
150050038	R3/8	19	12,5	17
150050048	R1/2	22,5	16	22
150050068	R3/4	27	19	27
150050088	R1	30	22	36

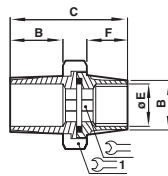

Flat Union

Model No.	Male BSPT (B)	C	ØE	F		
150331818	R1/8	33,5	15	10	5	15
150332828	R1/4	42	18,5	13	8	24
150333838	R3/8	43	19	13	10	27
150334848	R1/2	52	23	17,5	14	30
150336868	R3/4	56,5	25	19	17	38
150338888	R1	68	29	23	19	46

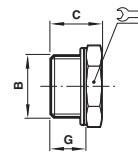

Plug

Model No.	Metric & BSPP Threads (B)	C	G	
160050005	M5	7,5	4	8
160050018	G1/8	10	6,5	14
160050028	G1/4	13	9	17
160050038	G3/8	13,5	9,5	19
160050048	G1/2	14,5	10	24
160050068	G3/4	16	11	30
160050088	G1	17	12	40

Supplied with sealing washer

# BSP & HOSE FITTINGS

M5, 1/8" to 1" BSP

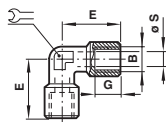

Elbow

Model No.	Female BSPP (B)	E	G	ØS	
160420018	G1/8	21	7	5,5	12
160420028	G1/4	25,5	9,5	8	13
160420038	G3/8	28	11,5	11	16
160420048	G1/2	32	15	15	20
160420068	G3/4	36,5	14,5	19	27

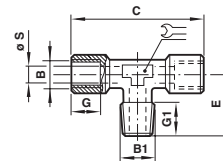

Tee

Model No.	Male BSPT (B1)	Female BSPP (B)	C	E	G	G1	ØS	
150690018	R1/8	G1/8	39	17,5	8,5	8	6	12
150690028	R1/4	G1/4	49	23	11	11	8	13
150690038	R3/8	G3/8	54	25,5	12	11,5	11	16
150690048	R1/2	G1/2	64	29	15	14	15	20

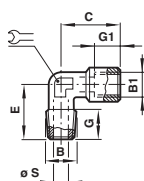

Elbow

Model No.	Male BSPT (B)	Female BSPP (B1)	C	E	G	G1	ØS	
150430018	R1/8	G1/8	21	18,5	8	7	5,5	12
150430028	R1/4	G1/4	25,5	24	11	9,5	8	13
150430038	R3/8	G3/8	28	27	11,5	11,5	11	16
150430048	R1/2	G1/2	32	29,5	14	13	15	20
150430068	R3/4	G3/4	36,5	32	14,5	14,5	19	27

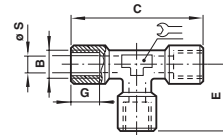

Tee

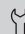
Model No.	Female BSPP (B)	C	E	G	ØS	
160620018	G1/8	39	19,5	8,5	6	12
160620028	G1/4	49	14,5	11	8	13
160620038	G3/8	54	27	12	11	16
160620048	G1/2	64	29	15	15	20
160620068	G3/4	73	36,5	14,5	19	27

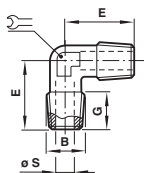

Elbow

Model No.	BSPT Thread (B)	E	G	ØS	
150400018	R1/4	18,5	7,5	6	12
150400028	R1/4	24	11	8	13
150400038	R3/8	27	12	11	16
150400048	R3/8	29,5	14	15	20

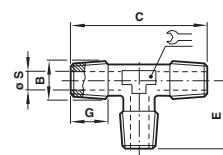

Tee

Model No.	BSPT Thread (B)	C	E	G	ØS	
150600028	R1/4	46	23	11	8	13

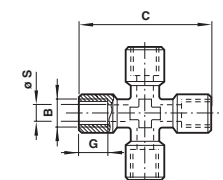

Cross

Model No.	Female BSPP (B)	C	G	ØS
160920018	G1/8	39	8,5	6
160920028	G1/4	50	11	8
160920038	G3/8	56	12	11
160920048	G1/2	64	15	15

## BSP & HOSE FITTINGS

M5, 1/8" to 1" BSP

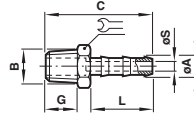

Hose Adaptor

Model No.	Hose Bore (ØA)	BSPT Thread (B)	C	G	L	ØS min.	
291170418	4	R1/8	32	7,5	19,5	3,2	12
291170618	6	R1/8	32	7,5	19,5	3,2	12
291170628	6	R1/4	35,5	11	19,5	3,2	14
291170638	6	R3/8	42,5	14,5	22,5	5	17
291170718	7	R1/8	32	7,5	19,5	5	12
291170728	7	R1/4	35,5	11	19,5	6	14
291170738	7	R3/8	36	11,5	19,5	6	17
291170828	8	R1/4	35,5	11	19,5	7,5	14
291170838	8	R3/8	36	11,5	19,5	7,5	17
291170918	9	R1/8	36	8,5	22,5	5	13
291170928	9	R1/4	41	12,5	22,5	7,6	14
291170938	9	R3/8	42,5	14	22,5	7,6	17
291170948	9	R1/2	45,5	17	22,5	7,6	22
291171018	10	R1/8	36	8,5	22,5	8,8	13
291171028	10	R1/4	35,5	11	19,5	7,5	14
291171038	10	R3/8	36	11,5	19,5	7,5	17
291171238	12	R3/8	36	11,5	19,5	9,5	17
291171328	13	R1/4	48,5	12,5	29,5	7	16
291171338	13	R3/8	49,5	14,5	29,5	11	17
291171348	13	R1/2	52,5	16,8	29,5	11	22
291171368	13	R3/4	55	18,5	29,5	11	27
291171638	16	R3/8	36	11,5	19,5	11	19
291171648	16	R1/2	39	14	19,5	12,5	22
291171668	16	R3/4	43,5	16,5	19,5	14,5	27
291171938	19	R3/8	58,5	14,5	38	11	22
291171948	19	R1/2	61	17	38	14	22
291171968	19	R3/4	63,5	18,5	38	17,5	27
291172568	25	R3/4	63,5	18,5	38	18	27
291172588	25	R1	67,5	21,5	38	22	35
291173288	32	R1	72,5	21,5	43	24	35

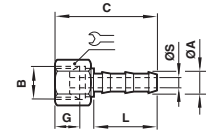

Swivel Hose Adaptor

Model No.	Hose Bore ØA	Female BSPP B	C	G	L	ØS	
302180428	1/4	G1/4	35	4,5	22,5	5,3	17
302180438	1/4	G3/8	36	6	22,5	5,3	22
302180628	3/8	G1/4	35	4,5	22,5	6,3	17
302180638	3/8	G3/8	36	6	22,5	8,3	22
302180748	1/2	G1/2	45	7,5	29,5	10,7	27

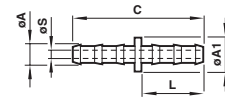

Hose Connector

Model No.	Hose Bore ØA	ØA1	C	L	ØS
300140404	1/4	9	47	22,5	5,3
300140505	5/16	12	47	22,5	7
300140606	3/8	13	47	22,5	8,3
300140707	1/2	16	62	29,5	10,7

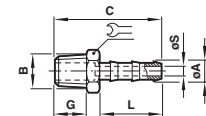

Hose Adaptor

Model No.	Hose Bore Inch/mm ØA	BSPT Thread B	C	G	L	ØS min.	
301170318	3/16	R1/8	36	8,5	22,5	4,2	10
301170328	3/16	R1/4	41	12,5	22,5	4,2	14
301170418	1/4	R1/8	36	8,5	22,5	5,3	10
301170428	1/4	R1/4	41	12,5	22,5	5,3	14
301170438	1/4	R3/8	42,5	14,5	22,5	5,3	17
301170448	1/4	R1/2	45,5	17	22,5	5,3	22
301170518	5/16	R1/8	36	8,5	22,5	5	12
301170618	3/8	R1/8	36	8,5	22,5	5	12
301170628	3/8	R1/4	41	12,5	22,5	7	14
301170638	3/8	R3/8	42,5	14,5	22,5	8,3	17
301170648	3/8	R1/2	45,5	17	22,5	8,3	22
301170728	1/2	R1/4	48,5	12,5	29,5	7	17
301170738	1/2	R3/8	49,5	14,5	29,5	10,7	17
301170748	1/2	R1/2	52,5	17	29,5	10,7	22
301170768	1/2	R3/4	55	18,5	29,5	10,7	27
301170988	3/4	R1	67,5	21,5	38	17,5	35
301171088	1	R1	67,5	21,5	38	22,4	35

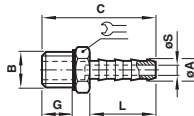

Hose Adaptor

Model No.	Hose Bore Inch/mm (ØA)	BSPP Thread (B)	C	G	L	ØS min.	
292170305	3	M5	15,5	3,5	7,5	2	8
292170318	3	G1/8	21	7,5	7,5	2	14
292170418	4	G1/8	36,5	7,5	22,5	3,3	14
292170428	4	G1/4	40,5	10	22,5	3,3	19
292170518	5	G1/8	36,5	7,5	22,5	4	14
292170618	6	G1/8	36,5	7,5	22,5	5	14
292170628	6	G1/4	40,5	10	22,5	5	19
292170638	6	G3/8	43	11,5	22,5	5	22
292170918	9	G1/8	36,5	7,5	22,5	7,5	14
292170928	9	G1/4	40,5	10	22,5	7,5	19
292170938	9	G3/8	43	11,5	22,5	7,5	22
292170948	9	G1/2	47	15	22,5	7,5	27
292171328	13	G1/4	47,5	10	29,5	11	19
292171338	13	G3/8	49,5	11,5	29,5	11	22
292171348	13	G1/2	54,5	15	29,5	11	27
292171368	13	G3/4	59,5	16,5	29,5	11	32
292171968	19	G3/4	67,5	16,5	38	17,5	32

Supplied with sealing washer.

## BSP & HOSE FITTINGS

M5, 1/8" to 1" BSP

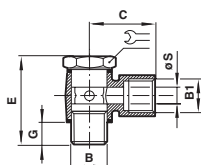

### Elbow Banjo Assembly Non-Regulating

Model No.	Male BSPP (B)	Female BSPP (B1)	C	E	G	ØS	
16A511818	G1/8	G1/8	21	29	5	6	14
16A512828	G1/4	G1/4	28	32	6	7,6	17
16A513838	G3/8	G3/8	31	45	9,5	9,6	22
16A513848	G1/2	G1/2	47	47	12	9,6	27

Female parallel BSP thread to male parallel BSP thread

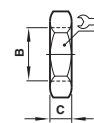

### Locknut

Model No.	BSPP Thread B	C	
36054601	G1/8	5	13
36054602	G1/4	6,5	17
36054603	G3/8	6,5	22
36054604	G1/2	6,5	27
36054606	G3/4	7	32

Natural brass finish

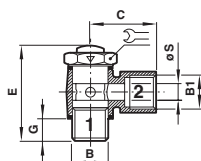

### Elbow Banjo Assembly Regulating Out

Model No.	Male BSPP (B)	Female BSPP (B1)	C	E	G	ØS	
16K512818	G1/8	G1/8	21	34	5	6	14
16K512828	G1/4	G1/4	28	37	6	7,6	17
16K513838	G3/8	G3/8	31	52	9,5	9,6	22
16K512848	G1/2	G1/2	47	58	12	9,6	27

Arrow on bolt hexagon indicates free flow direction

Pressure range 1 to 10 bar

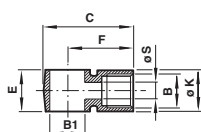

### Elbow Banjo Body

Model No.	Female BSPP B	Bolt Thread B1	C	E	F	ØK	ØS
160511818	G1/8	1/8"	28	14	21	13	6
160512828	G1/4	1/4"	37	16	28	16	7,6
160513838	G3/8	3/8"	42	20,5	31	20,5	9,6
160514848	G1/2	1/2"	61	22	47	24,5	9,6

Female parallel BSP thread